

INSTALLATION

ENGLISH

WARNINGS AND CAUTIONS:

- CHOKING HAZARD -- Small parts. Not for children under 3 yrs.

TO INSTALL

1. Identify the light switch you want to lock.

Position the light switch in ON or OFF state, depending on your needs.

Next, locate the gaps surrounding the light switch lever (Figure 1a).

Take one Toggle Shield® Industrial part and locate features 1 & 2 in figure 2.

2. Grab a Toggle Shield® Industrial and start inserting it on the light switch lever focusing on the Top wing.

The Top wing should fit in the opening in Figure 1a. (See figures 3 & 4).

3. Make sure that the bottom leg is in the light switch opening (Figure 1a). You can move the bottom leg up if it's not in the opening. Next, push on the flat zone behind the bottom leg of the Toggle Shield® until you hear a few clicks (Figure 5). Keep pushing until the part is locked in place with no free play.

Final locked position will look like Figure 6.

Congratulations Your light switch is locked!



Fig. 1



Fig. 1a

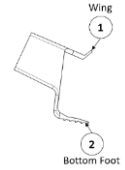

Fig. 2

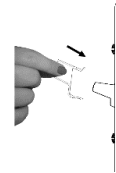

Fig. 3

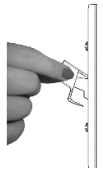

Fig. 4

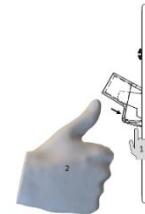

Fig. 5



Fig. 6

TOGGLE SHIELD® INDUSTRIAL



TO REMOVE

1. Push up on the rear most corner of the part that is towards you. (Figure 7)
The bottom leg of Toggle Shield® will disengage from the light switch.
2. Now simply grab the Toggle Shield® head and pull it towards yourself (Figure 8 & 9).

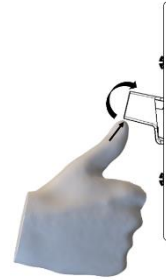

Fig. 7

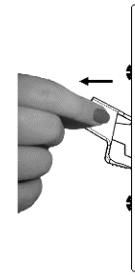

Fig. 8

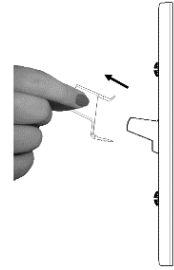

Fig. 9

Scan this QR code to watch the installation instructions on YouTube.

